

Easy DIY Adjustable Dog Collar



Instructions

1



Measure your pet's neck with measuring tape and add 11"- 12" to that length. The total will be the length of webbing you will need to make the collar.

Note: Use an existing collar as a reference.

2



OPTIONAL

Glue or sew on decorative trim or fabric onto the webbing.

3

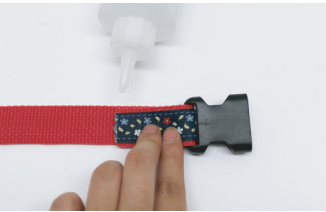

Loop in the receiving end of your parachute clip on one end of the collar. Leave 1"-2" of the end to glue or sew down.

4



Loop slider from the opposite end, followed by your D ring, then the inserting end of your parachute clip.

5



Loop webbing back into the slider from underneath.

6



Secure slider, leaving 3-4cm (1"-2") of the webbing to glue or sew down.

Supplies



- Ruler/Measuring Tape
- Fabric Glue/Needle & Thread
- Scissors
- Webbing (1/2"- 1" thick)
- D Ring
- Parachute Clip
- Slider
- Decorative Trim or Fabric (optional)

Note: For best results, use a sewing machine to secure ends.

Final Result



Mix and match with various combinations of notions!